

{Tahoma|b1|i0|c0|p34|ELEVATION DATUM USED INVERT ELEVATION OF SANITARY SEWER MANHOLE #24-13, I.E.=627.00' AS PER WHATCOM COUNTY WATER AND SEWER DISTRICT NO. 10 AS-BUILTS. MEASURE UP TO RIM 7.10' FOR A RIM.

LEGEND

- ⊙ FOUND BRASS DISK MONUMENT
- ⊙ FOUND CONCRETE MONUMENT
- SET 1/2" REBAR/CAP (LS #18897)
- SET PROP. LINE STAKE
- WV WATER VALVE
- FH FIRE HYDRANT
- X MISC. FEATURE (SEE NOTES)
- ⊙ TREE LABELED W/ INCH DIA. & SPECIES (A=ALDER, C=CEDAR, F=FIR, H=HEMLOCK, M=MAPLE)
- DITCH CENTERLINE
- - - - - EDGE OF PAVEMENT

{Tahoma|b1|i0|c0|p34|DATE OF SURVEY MARCH 28, 2005

house footprint
1980 sq. ft.
Driveway and walk imperv. area = approx. 390sq.ft.
Lot size 9075 sq. ft.
total impervious= 2370sq. ft.
percent impervious = 26%

address: 20 Shetland Ct.
legal: lot 87, Sudden Valley, Div. 24
Tax parcel# 370407 226253 0000

{Tahoma|b1|i0|c0|p34|LEGAL DESCRIPTION LOT 87, PLAT OF SUDDEN VALLEY, DIVISION NO. 24, ACCORDING TO THE PLAT THEREOF, RECORDED IN VOLUME 12 OF PLATS, PAGES 4 THROUGH 7, INCLUSIVE, RECORDS OF WHATCOM COUNTY, WASHINGTON.

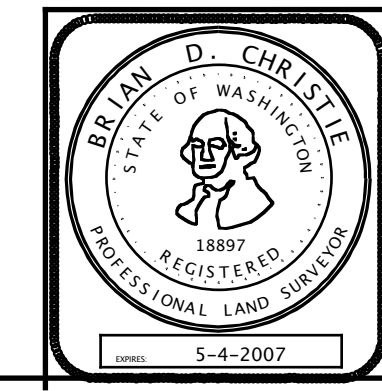

CHRISTIE & CHRISTIE
LAND SURVEYING INC.

222 GRAND AVE. SUITE 'D',
BELLINGHAM, WASHINGTON 98225
PH. # 360.671.8855, FAX # 360.671.8823,

PREPARED FOR:	AIKI HOMES, INC. PO BOX 29977 BELLINGHAM, WA 98228-1977	
DATE:	APR. 2005	DRAWN BY: JCA
SCALE:	AS SHOWN	CHECKED BY: BDC
		JOB NO. 2502029C LOT87DIV24.DWG SHEET 1 OF 1